

Notes:

- Units number from North to South, and East to West.
- Top Hang Mezzanine Units.
- Top Hang Balcony Units
- Top Hang Balcony Toe Rail Units, **Except** for PAR64s Which are to be Side Hung.
- Side Hang Catwalk Units
- Use Side arms to hang Catwalk Units as Indicated.
- See Paperwork for Houselight, and Restroom Light Patch.
- Indicated two-fers are optional - ME's Option
- Optional two-fers indicated with dashed line requires circuiting to 50A dimmer.

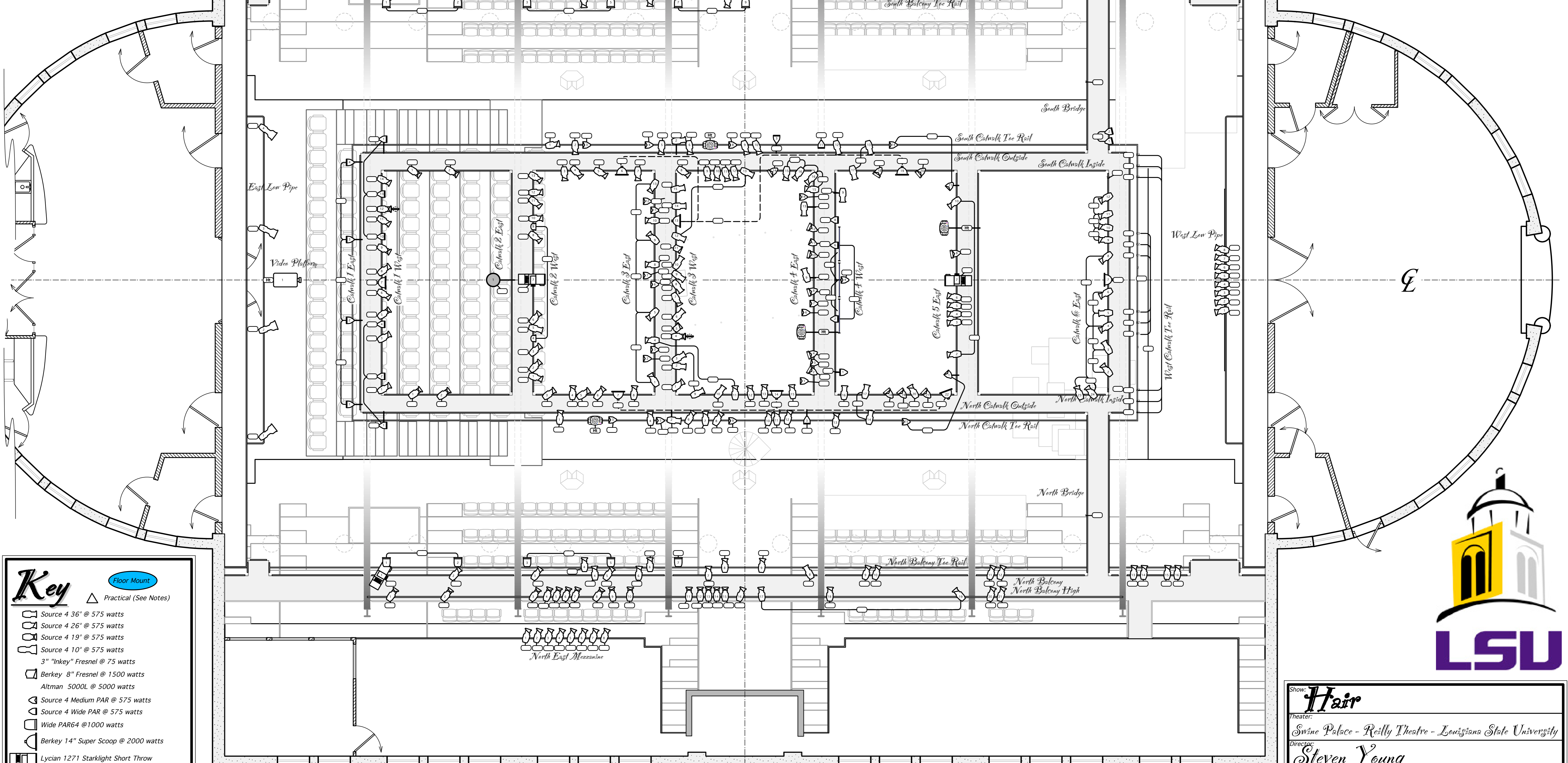
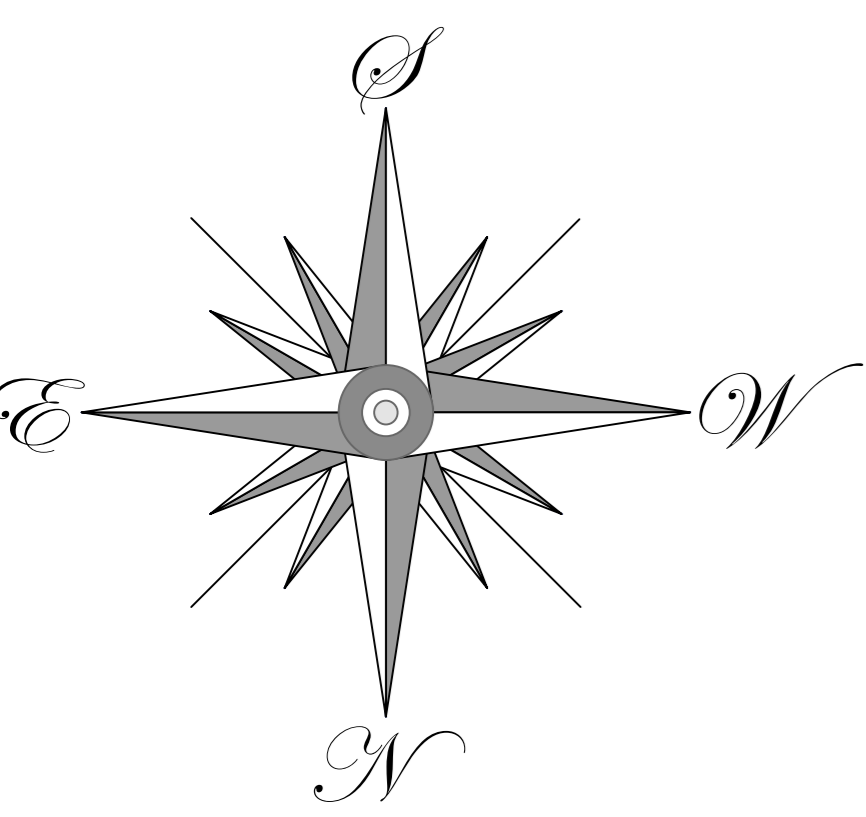

Key

Floor Mount
 △ Practical (See Notes)

- Source 4 36" @ 575 watts
- Source 4 26" @ 575 watts
- Source 4 19" @ 575 watts
- Source 4 10" @ 575 watts
- 3" "Inkey" Fresnel @ 75 watts
- Berkey 8" Fresnel @ 1500 watts
- Altman 5000L @ 5000 watts
- Source 4 Medium PAR @ 575 watts
- Source 4 Wide PAR @ 575 watts
- Wide PAR64 @ 1000 watts
- Berkey 14" Super Scoop @ 2000 watts
- Lycian 1271 Starklight Short Throw
- Sanyo XF-50 Video Projector
- Studio Spot CYM @ 575 watts
- Altman Far Cyc

3' Strip Berkey Strip Altman Strip Altman Zip Strip
 AF-1000 Strobe Wybron Color Ram II
 Rosco I-Cue Mirror Ball w/1RPM Motor 4' Blacklight



Show: **Hair**
 Theater: **Swine Palace - Reilly Theatre - Louisiana State University**
 Director: **Steven Young**
 Plate: **1** Scale: **3/16" = 1' - 0"** Date: **April 1, 2008**
 Designer: **Ken White** View: **Master Plot**
 M.E.: **Pat Acampora** Draft: **K.W. (VectorWorks 2008)**